

R-XSR + R-XFR

AMERLUX RETROFIT INSTALLATION INSTRUCTIONS



IMPORTANT: Read **ALL** instructions before starting installation.

CAUTION: To reduce risk of shock, **TURN OFF ELECTRICAL SUPPLY** before installing/servicing fixtures.

WARNING: Fixture must be installed in accordance of National Electrical Code (NEC) and/or any local codes. *Failure to do so may result in serious injury and/or damage to the fixture.*

RECOMMENDED TOOLS

**Screw Driver
(Phillips)**



**Wire
Cutter/Stripper**



SAFETY INSTRUCTIONS

- Observe and follow all label information and instructions regarding dry, damp and wet location listings, proper lamp type and wattage, warnings of installation near combustible materials and/or insulation.
- Turn off power at circuit breaker before attempting to install or perform maintenance on the fixtures.
- **WARNING: RISK OF FIRE OR ELECTRIC SHOCK.** Luminaire wiring and electrical parts may be damaged when drilling for installation of LED retrofit kit. Check for enclosed wiring and components. LED retrofit kit installation requires knowledge of luminaires electrical systems. If not qualified, do not attempt installation, and contact a qualified electrician.
- Install this kit only in luminaires that have the construction features and dimensions shown in the drawings and where the input rating of the retrofit kit does not exceed the input rating of the luminaires.
- Only the open holes indicated in the drawings may be made or altered as a result of kit installation. Do not leave any other open holes in an enclosure of wiring or electrical components. Do not make or alter any other open holes in an enclosure of wiring or electrical components during kit installation.
- **WARNING:** To prevent wiring damage or abrasion, do not expose wiring to edges of sheet metal or other sharp objects.
- This retrofit kit is accepted as a component of a luminaire where the suitability of the combination shall be determined by authorities having jurisdiction.

R-XSR + R-XFR

AMERLUX RETROFIT INSTALLATION INSTRUCTIONS



MODEL INFORMATION

- **MODELS R-XFR11-20, R-XSR11-24:** Suitable for field installation in any recessed luminaire frame with metal frame min. 0.026" (0.66 mm) thick, overall dimensions 9.0" by 7.0" with 5.5" by 5.5" opening; provided with flanges for spring clips, junction box and flexible conduit
- **MODELS R-XFR12-20, R-XSR12-24:** Suitable for field installation in any recessed luminaire frame with metal frame min. 0.026" (0.66 mm) thick, overall dimensions 12.0" by 9.0" with 10.5" by 5.5" opening; provided with flanges for spring clips, junction box and flexible conduit
- **MODELS R-XFR13-20, R-XSR13-24:** Suitable for field installation in any recessed luminaire frame with metal frame min. 0.026" (0.66 mm) thick, overall dimensions 16.5" by 9.0" with 15.0" by 5.5" opening; provided with flanges for spring clips, junction box and flexible conduit
- **MODELS R-XFR14-20, R-XSR14-24:** Suitable for field installation in any recessed luminaire frame with metal frame min. 0.026" (0.66 mm) thick, overall dimensions 21.0" by 9.0" with 19.0" by 5.5" opening; provided with flanges for spring clips, junction box and flexible conduit

ORIGINAL PRODUCT REMOVAL INSTRUCTIONS

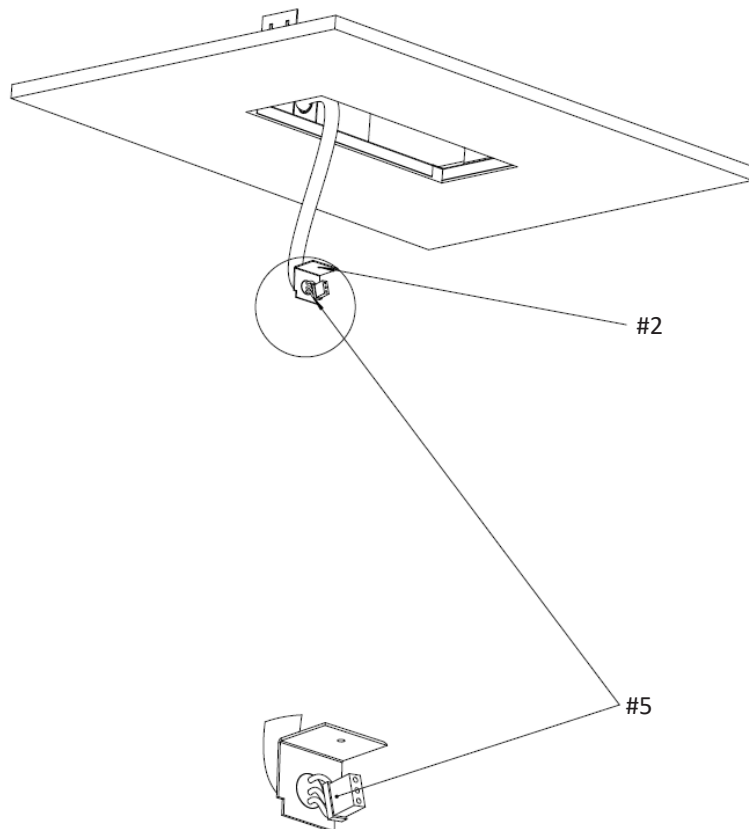

1. Remove obsolete assembly from the ceiling.
 - Pull fixture away from the ceiling using the flanges at the perimeter of the aperture.
 - Compress side springs to fully release assembly from ceiling.
2. At this point the obsolete fixture would be hanging from the frame, proceed to unscrew bracket attached to obsolete assembly's electrical wiring compartment.
3. Unplug connector.
4. Remove obsolete assembly.
5. Prepping wiring for proper connections :
 - **Option 1:** Remove connector from bx wiring (coming from the junction box secured to the frame) by cutting connector from leads. Leave (hot, neutral and ground) wires free to make connections in floating box.
 - **Option 2:** If connector is provided/assembled in SLG retro fit kit leave connector as it is (do not cut from wires).

R-XSR + R-XFR

AMERLUX RETROFIT INSTALLATION INSTRUCTIONS



RETROFIT INSTRUCTIONS

5. (Continued) Replace thermal protector in assembly with supplied Sensata RP-13A or Leviton 9454 thermal protector.

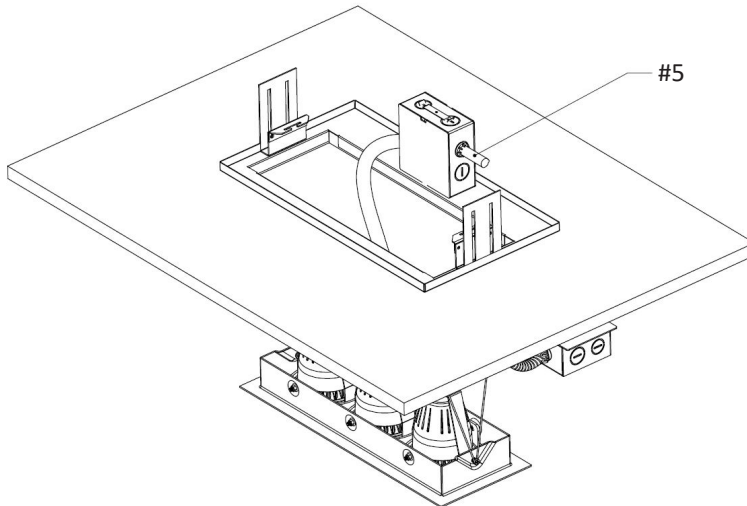

- Disable the assembled thermal protector by undoing connections, crimping the inner springs and pulling away from the wiring compartment.
- Proceed to install the thermal protector by inserting into knock out and wire according to the diagram shown.

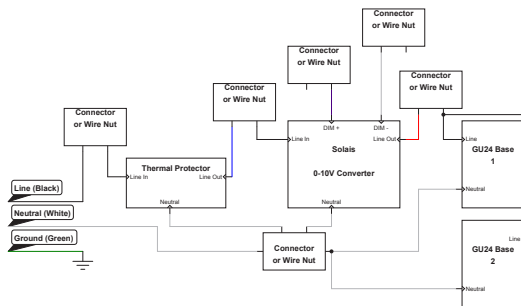

6. Make connections to retrofit kit using leads located in floating box:

- **Option 1:** Use provided wire nuts to make proper connections as needed (hot, neutral, & ground).
- **Option 2:** Plug connectors.

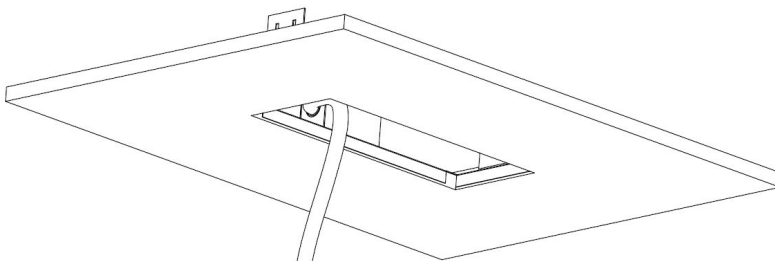

#7

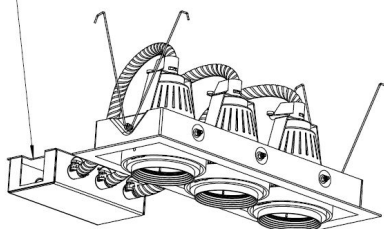

7. After making wiring connections secure bracket to floating electrical box.

R-XSR + R-XFR

AMERLUX RETROFIT INSTALLATION INSTRUCTIONS



RETROFIT INSTRUCTIONS

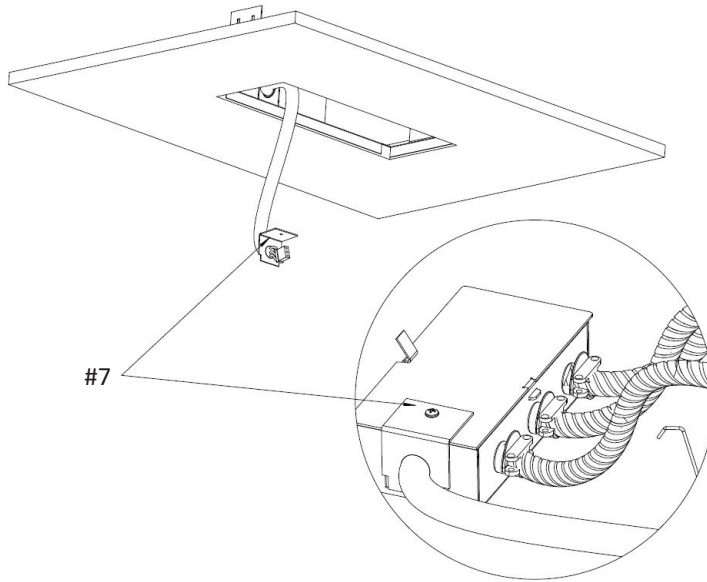

7. (Continued) Use provided M4 screw to secure BX bracket to floating box (after making sure all wiring is done).

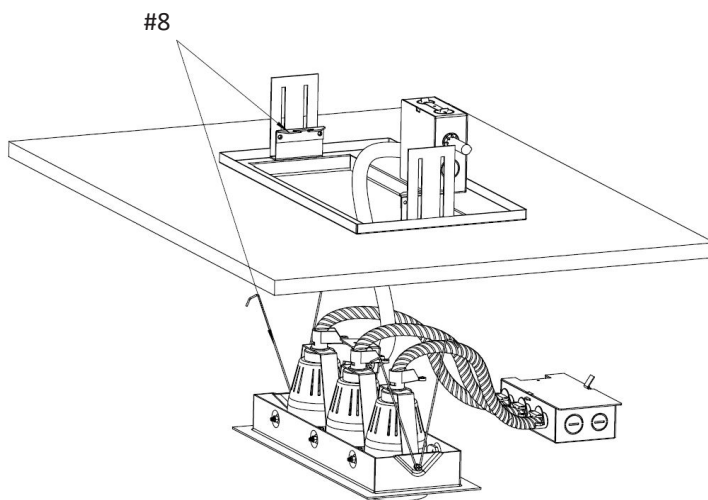

8. After all connections have been made and bracket has been secured, insert floating box through aperture and compress/align retrofit kit springs. Push and insert retrofit kit into ceiling until springs fully compress and expand securing the assembly in the frame.

